

USER MANUAL

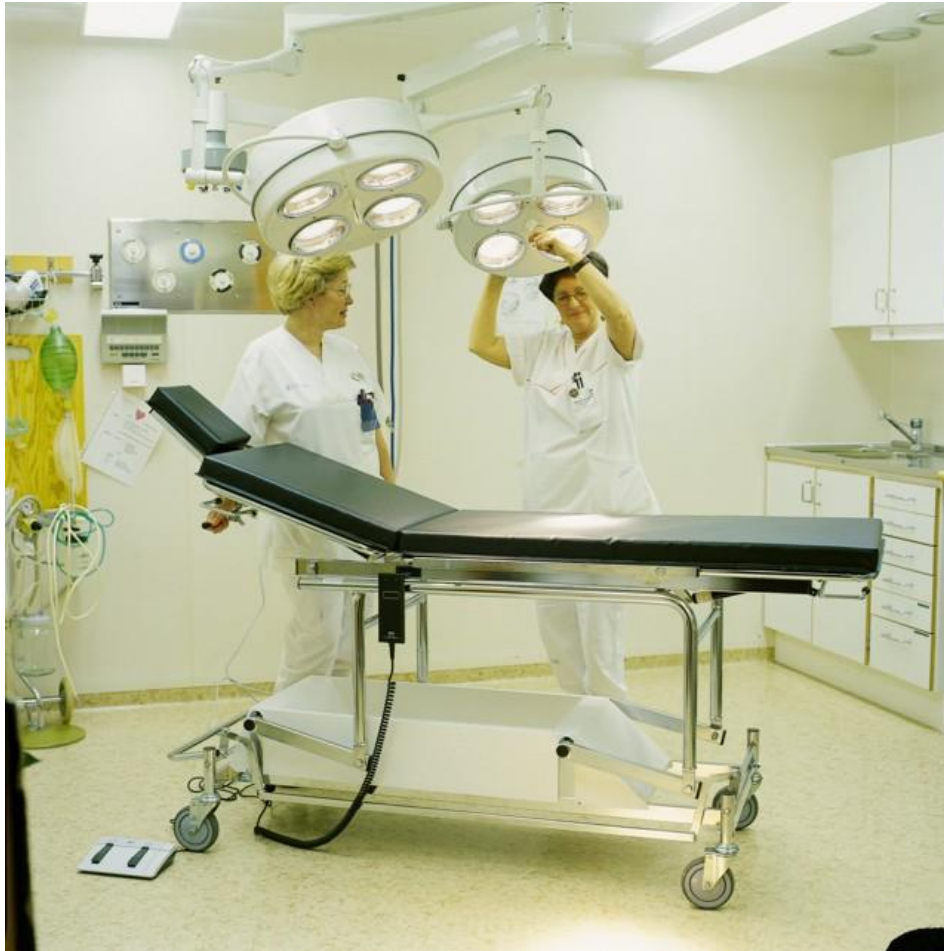

POLICLINIC TABLE

For model
011-3500

NOTE!

**The operator must read the user manual
carefully BEFORE the product is used,
to avoid unnecessary risks to the patient and operator.**

TABLE OF CONTENTS

Foreword

Warranty

Important information

1. Function Description

1.1 General description

2. Operation

2.1 Connection

2.2 Height adjustment

2.3 Adjusting the backrest

2.4 Adjusting the Trendelenburg

2.5 Adjusting the headrest

2.6 Paper-roll holder

2.7 The function of the castors

3. Maintenance & Cleaning

3.1 Routine check-ups

3.2 Cleaning

3.3 Lubrication scheme

3.4 Spare parts

3.5 Accessories

3.6 Solutions for lubrication, cleaning and disinfecting

4. Technical specification

4.1 Dimensions

4.2 Motors and control units

4.3 Battery backup

4.4 Labels

5. EU-Declaration of Conformity

6. Contact details

FOREWORD

Welcome as the owner of a product manufactured by Sjöbloms Sjukvårdsutrustning AB. We hope that you will be pleased and satisfied with our quality product.

If a problem should arise with this or any of our products, you are always welcome to contact us, and our service department will assist you with the expertise needed to solve the problem.

The user manual contains all the information needed to use, maintain and service the product. The document is continuously updated as the products are modified. Therefore we reserve against possible changes in the user manual.

WARRANTY

Sjöbloms provides a two-year warranty for material, design and manufacturing defects, provided the products are not subjected to tampering or excessive wear. For the guarantee to apply, the product must have been used in accordance with the user manual, and the maintenance performed as specified.

IMPORTANT INFORMATION

This product is intended for professional medical use. The user manual should be read carefully before using the product, to avoid unnecessary risks for the patient and operator.

The user manual contains warnings where there is a risk of personal injury, which should be noted. Improper handling can be fatal.

A warning triangle is shown where particularly important information can be found.



Warning triangle

1. FUNCTIONAL DESCRIPTION

This product is meant for professional use in health care, for examination of the patient.

It is designed to be a functional and user-friendly tool for the operator and patient.



Note that the product must only be used by competent health professionals who read the user manual, for correct handling.

General description

3-sectioned Policlinic table, electrically height adjustable. Chromium-plated all-welded steel tube chassis. Backrest and Trendelenburg position adjusted by gas-spring, headrest adjustable manually. Accessory rails on both sides along the whole length of the table.

All-welded 40 mm pad.

125 mm castors, directional locking device for longer straight transportations.

2.1 Connection

The contact should be connected to a grounded 230V outlet. The product is now ready for use.

2.2 Height adjustment

Hand and foot control are included

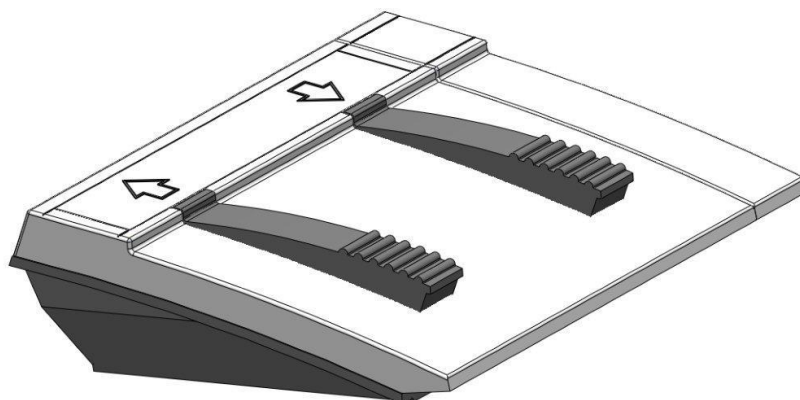

Follow the symbols and arrows to regulate the couch.



NOTE!

Ensure that no unauthorized persons are in the product's working range, as a pinch hazard exists when raising and lowering the product.

2.3 Adjusting the backrest

Raising the backrest

Press the handle on the backrest (arrow). The gas spring helps raising the backrest.

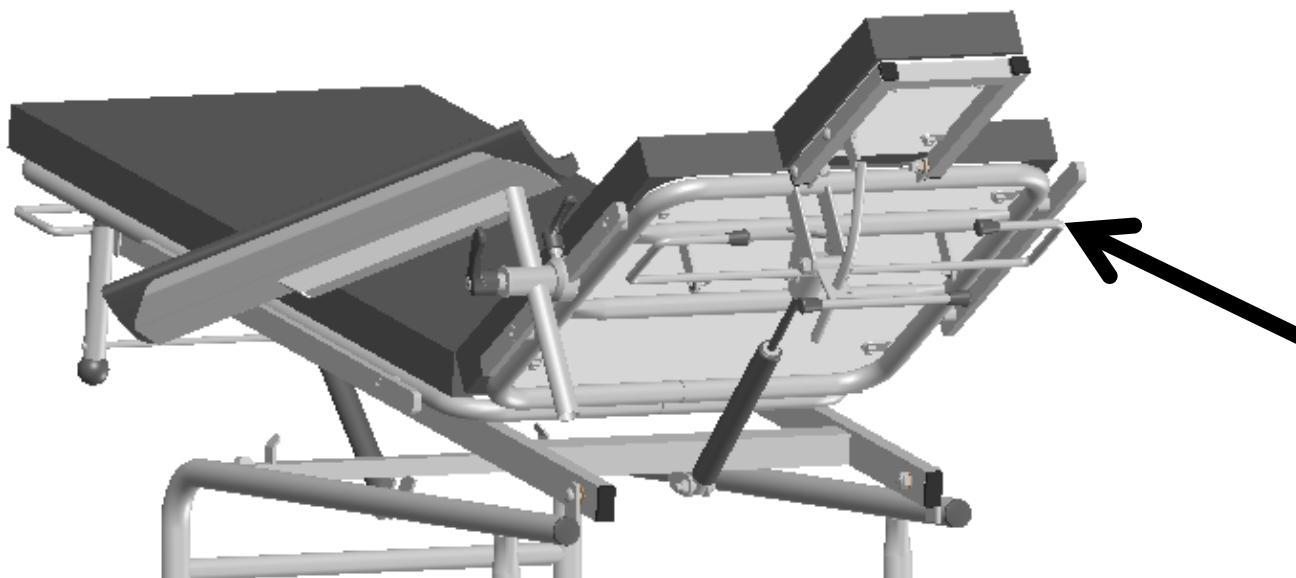

Lowering the backrest

To lower the backrest, press the handle and help the backrest down.

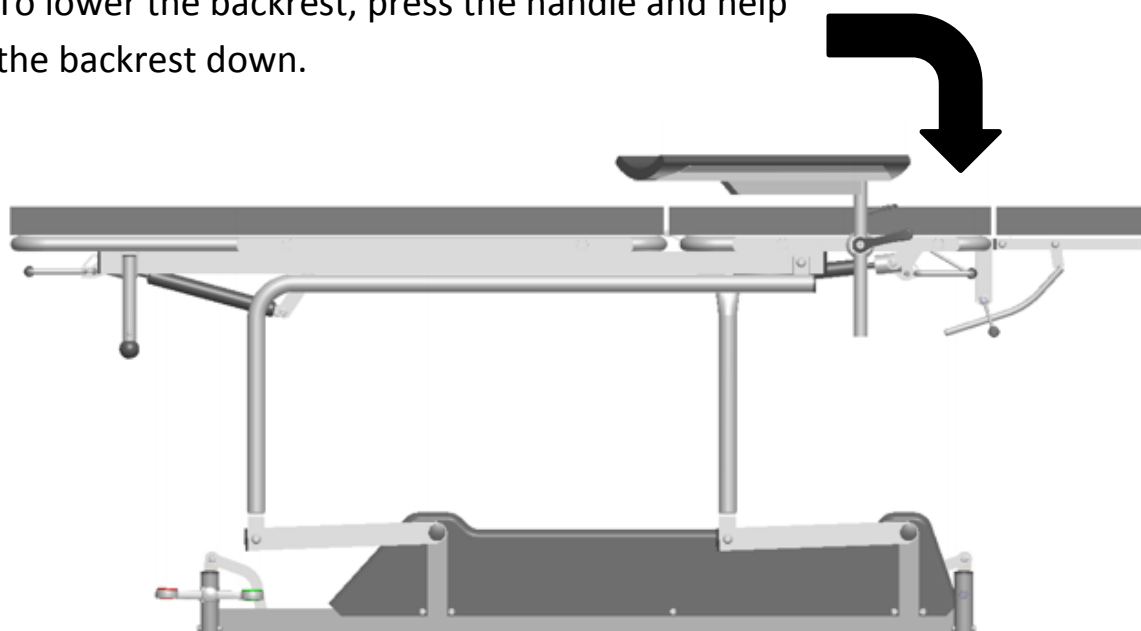

NOTE!

Ensure that no unauthorized persons are in the product's working range, as a pinch hazard exists when raising and lowering the product.

2.4 Adjusting the Trendelenburg position

Raising the Trendelenburg position

Press the handle on the foot-end side (arrow). The gas spring helps raising the backrest.

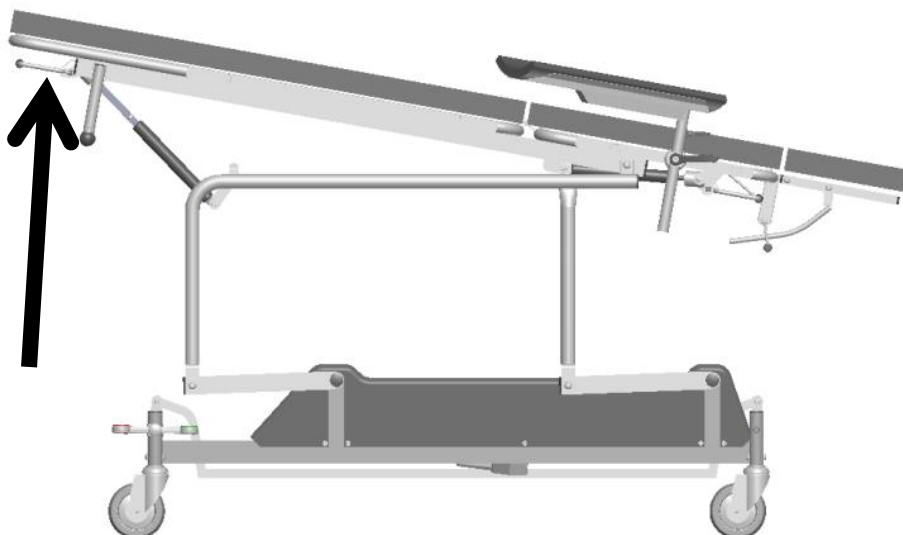

Lowering the Trendelenburg

To lower the Trendelenburg, press the handle and help the foot-end down.

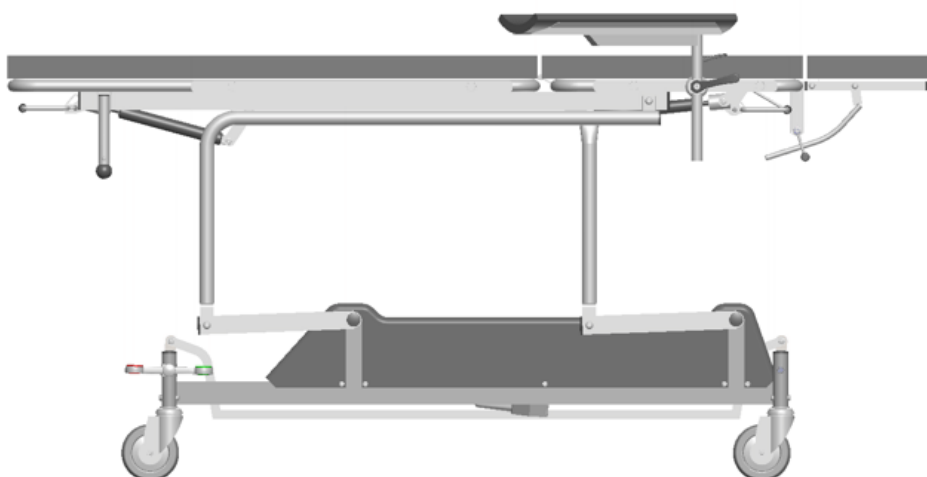

2.5 Replacing the paper roll

- a) Unscrew the black ball.
- b) Push the metal rod to the left.
- c) Pull the rod gently towards you until it comes loose on the right side.
- d) Pull the rod gently to the right.
The rod is now loose and you can put on a new paper roll.
- e) Put the rod back on the left side.
- f) Put the rod back on the right side, in the score.
- g) Push the rod to the right.
- h) Screw the ball tight again.

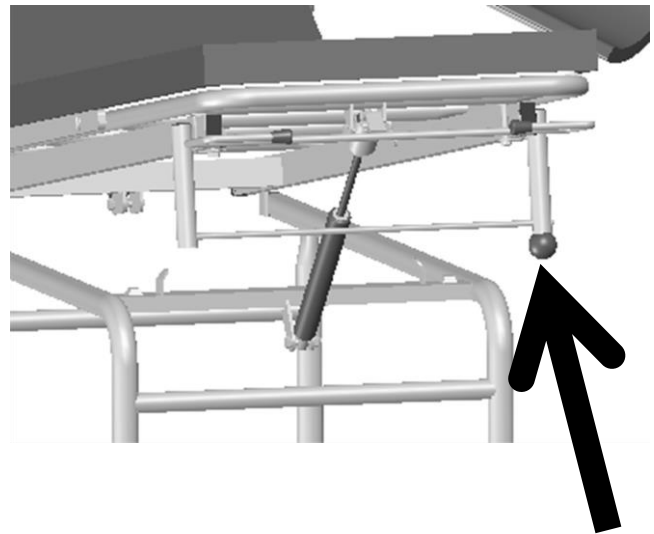

2.6 The function of the castors

The 3-sectioned table is equipped with 125 mm central-locking castors.

Central-locking castors

Free castors

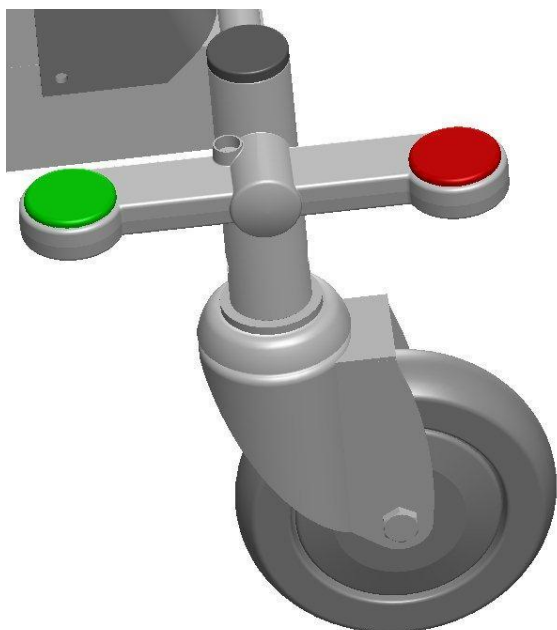

Braked castors

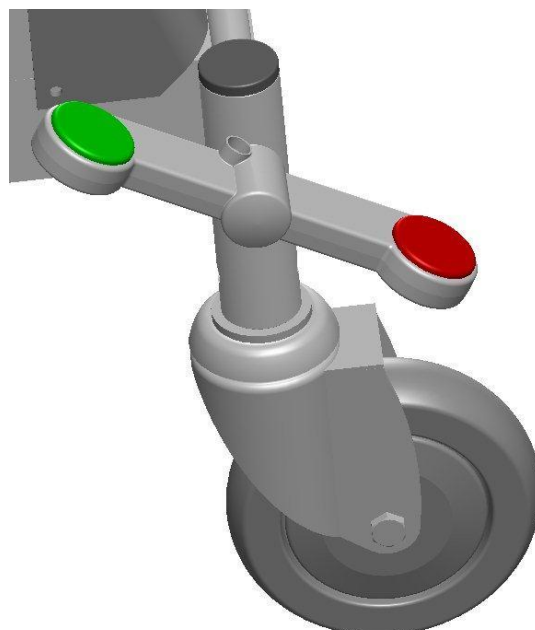

Directional locked castors

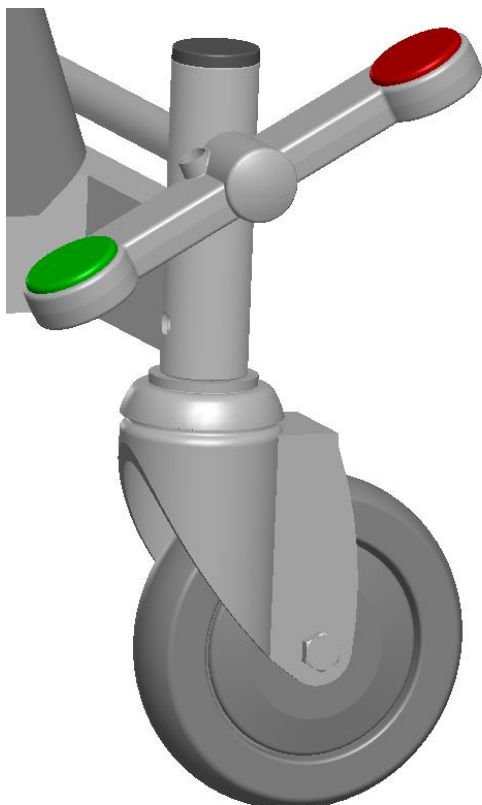

3. MAINTENANCE & CLEANING

3.1 Routine check-ups

Routine check-ups should be made to ensure proper functionality.



Important!

Failure to perform the following routine can cause the patient and/or operator to be exposed to unnecessary risks and the couch may have a reduced life expectancy. Please check all functions and parts on a regular basis.

Check the following:

- Any unusual sounds.
- Gas spring functions.
- Castors and castor locking mechanism.
- Damages to electric cables.
- The motor function.
- That joints and fittings are lubricated according to the lubrication chart.

3.2 Cleaning

Disinfection

If the product needs to be disinfected, preferably use a diluted alcohol. Too strong an alcohol solution can have a drying effect, which means that the imitation leather's properties deteriorate and cracks can form.

3.3 Lubrication scheme

Lubrication according to the scheme should be performed every 6 months or as needed.

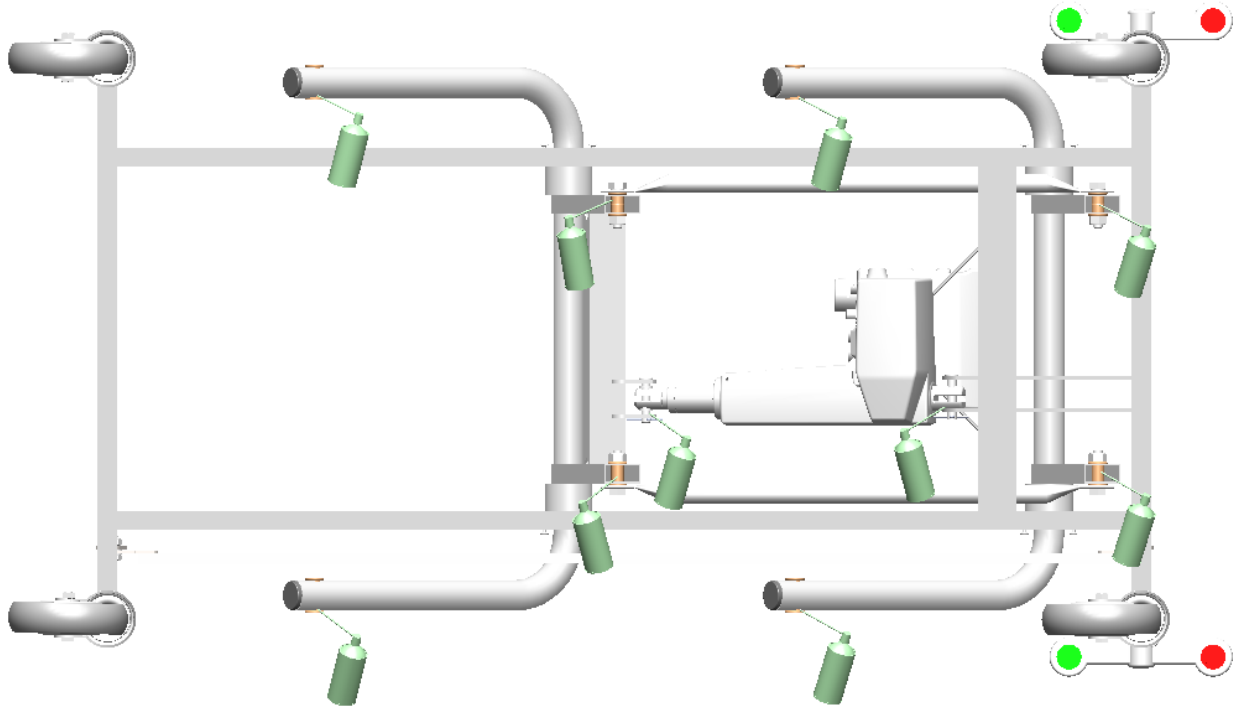

ELEKTRIC

1. First lock the castors.
2. Enlist the help of another person and tip the couch on the side, in order to lubricate the moving joints.

The spray can above indicates where to lubricate.



3.4 Spare parts

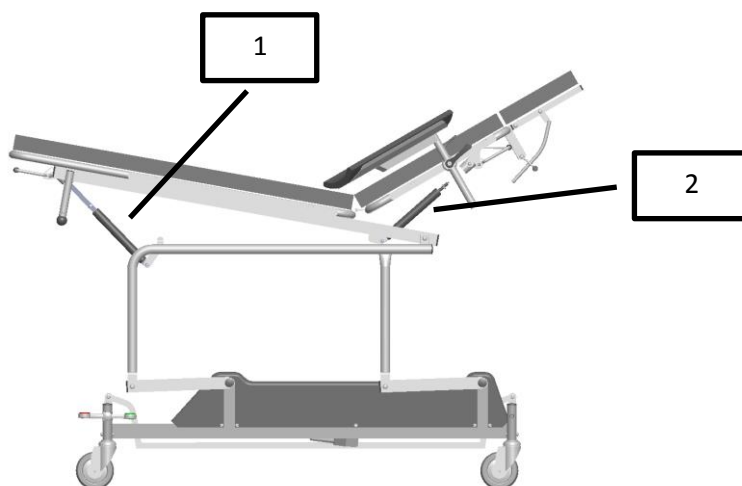

No.	Art no	Article
1-2	G0002	Gas spring
3	010-8540	Paper roll holder including ball
4	125321630T2LPZ	Castor, central-locking
5	125321630T3LPZ	Castor, central-locking, directional-locking
6	HB7160001+20500	Hand control, one motor, Linak
7	FS1001	Foot control, one motor, Linak
8	CB9140AE3+000F0	Control unit, Linak
9	343100+0015004A	Lifting motor, Linak

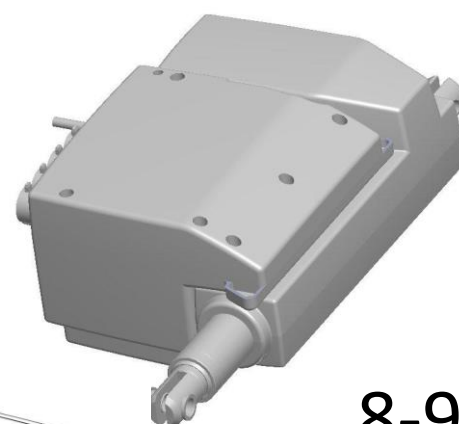
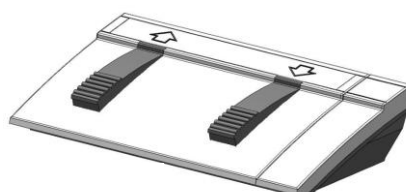
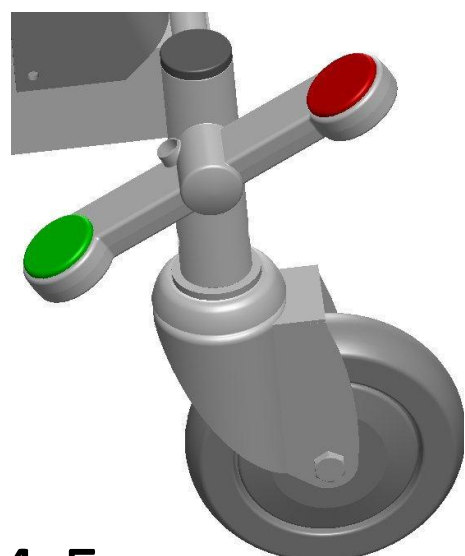
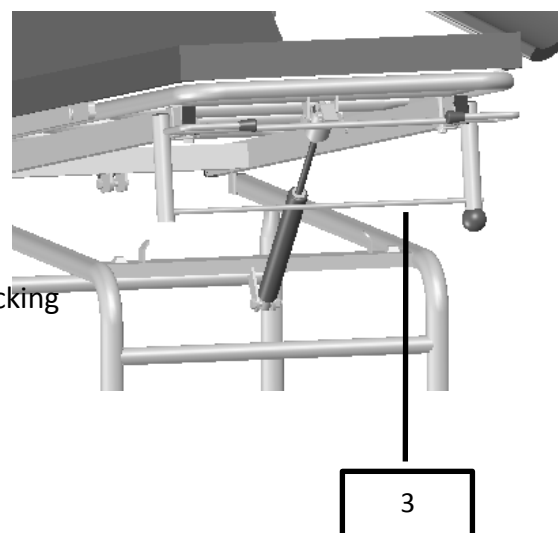

4-5

6

7

8-9

3.5 Accessories



Anesthetic bow, armrest with pad



IV stand

Accessories not in picture

Battery backup

3.6 Solutions for lubrication, cleaning and disinfecting

R-1, Cleaning solution for artificial leather

5557001, Lubrication

C068, Disinfection solution, DAX Plus

Use these or local equivalents.



Cleaning solution



Lubrication



Disinfection

4. TECHNICAL SPECIFICATIONS

4.1 Dimensions

Length: 200 cm

Width: 50 cm

Height: 75-112 cm

Backrest, length: 75 cm

Backrest, angle: +64°

Headrest, angle: +40°, -90°

Trendelenburg, angle: -10°

Weight: ca 66 kg

Max patient weight: 180 kg

SWL: 200 kg

4.2 Motors and control units

Duty cycle: Max 10% or 2 minutes continuous use followed by 18 minutes not in use

Ambient temperature +5°C to +40°C.

The CARELINE system has full compliance with EN 60601-1.

4.3 Battery backup

(optional)

General

The batteries used in the control unit are sealed lead batteries.

The included power cord should be plugged into an electrical outlet with 230 volts. The charger will recharge the battery in less than 12 hours. The charger can safely be connected for charging for extended periods.

If a battery is not used for a long time, it will gradually lose its stored energy. It is therefore recommended that the batteries are recharged at least 8 hours before usage.

Battery life

Battery life depends on several factors including the extent of discharging. If the battery is discharged too extensively between charges the lifespan will be reduced. Charging as often as possible is recommended.

The built-in buzzer "Charge the battery" that is built into the controller will sound when a discharge of 50% has occurred.

The life expectancy of the batteries is about 500-1200 charge cycles.



NOTE!

When the battery is depleted, the battery should be brought to a battery collection, if applied in your country, to conserve the environment.

4.4 Labels on the product

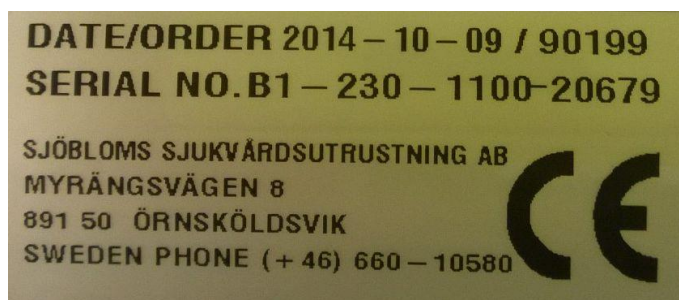

The CE label contains the date, order number, serial number and our contact information.

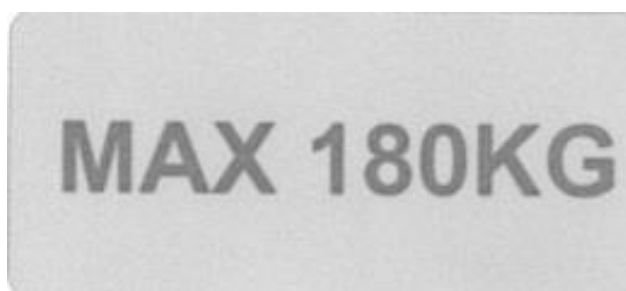

Max patient weight 180 kg.



Displays the adjustment of the backrest. There is a label on each side of the table.

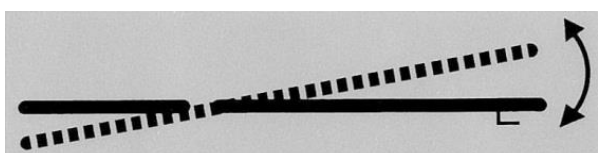

Displays the adjustment of the Trendelenburg position. There is a label on each side of the table.

5. EU-DECLARATION OF CONFORMITY

EU-DECLARATION OF CONFORMITY

according to MDD 2007/42/EC including Appendix
and according to CE-marking Directive 93/68/EEC

Type of equipment: Examination table, hydraulic or electric

Manufacturer: Sjöbloms Sjukvårdsutrustning AB

Model: 011-3500 Product registration number: 13958

Manufacturer

Sjöbloms Sjukvårdsutrustning AB

Myrängsvägen 8

S-891 50 ÖRNSKÖLDSVIK, SWEDEN

Sjöbloms Sjukvårdsutrustning AB ensures that the above products are in accordance with the EU Council MDD 93/42/EEC, as well as the Swedish legislation in force (1993:584) on medical devices and the regulations issued by Medical Products Agency (LVFS 2003:11).

Örnsköldsvik 2011-06-22



Karl-Gunnar Sjöblom

Production Manager

6. CONTACT INFORMATION

SJÖBLOMS

Myrängsvägen 8

891 50 Örnsköldsvik

Sweden

Tel: +46 660 105 80

Fax: +46 660 180 00

E-mail: info@sjobloms.com

Web page: www.sjobloms.com