

Electric Mayo and serving tables

Chassis

The chassis is made in stainless steel tubes, The stainless steel column with integrated motor.

The control box is rechargeable, 50 max adjustments per charge. Charger is included.

Castors

Stainless steel castors with ball bearings, grey.

Capacity

Height 800-1200 mm.
Max load 50 kg.

Accessories

Foot control
Antistatic castors

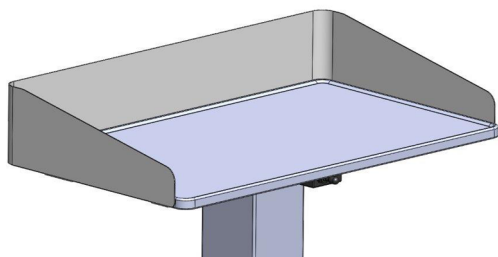

Stainless steel plate border

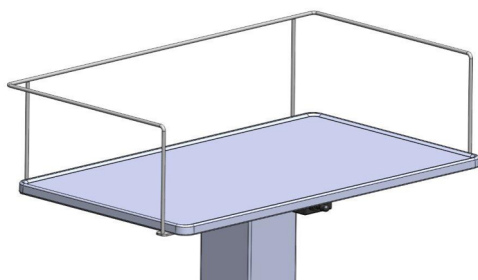

Stainless steel thread border



020-5050



020-7060

Item

Mayo table, 60x40 cm
Mayo table, 70x50 cm
Mayo/serving table 70x50 cm
Mayo/serving table 95x55 cm
Mayo/serving table 107x57 cm

Art no

020-5040
020-5050
020-7050
020-7060
020-7070

Accessories

Foot control
Antistatic castors
Border, stainless steel plate or thread